



Table of Contents

INTRODUCTION	3
Parts Check List:	4
IMPORTANT SAFETY INSTRUCTIONS	5
REPLACING THE HANDSET BATTERIES	7
GETTING STARTED	9
Setting Up Your VTECH 914 ADLi	9
WALL MOUNTING	11
HANDSET FEATURES	13
IN USE LED	13
LOW BATTERY LED	13
PHONE KEY / FLASH FUNCTION	13
CHANNEL KEY	13
OFF KEY	13
MEM KEY	13
PROG KEY	13
REDIAL KEY	13
TONE/ *KEY	13
VOLUME CONTROL	13
BASE UNIT FEATURES	14
POWER LED	14
CHARGE LED	14
IN USE LED	14
SPARE BATTERY LED	14
PAGE KEY	14
TONE/PULSE SWITCH	14
OPERATING INSTRUCTIONS	15
Making Calls	15
Answering Calls	15
Disconnecting	15
Changing Channels	15
Temporary Tone	16
Programming The Ringer Type	16
Turning Off The Ringer	16
Checking The Ringer	17
Memory Dialing	17
Programming Speed Dial Numbers	17
Speed Number Dialing	17
To Change or Replace a Speed Dial Number	17
Storing Special Codes	17
Using Redial	18
Storing a Redial Number into Speed Dial	18
The Page Feature	19
ITAD BASE LEDS	20
MAILBOX LED's	20
ON LED	20
FULL LED	20
ITAD BASE KEYPAD FUNCTIONS	21
ANSWER ON KEY	21
MAILBOX KEY	21
RECORD/MEMO KEY	21
MENU KEY	22
SELECT KEY	22



Table of Contents

- SET/CLOCK KEY 22
- PLAY KEY 22
- ERASE KEY 23
- REPEAT KEY 23
- STOP KEY 23
- SCAN KEY 24
- VOLUME UP KEY 24
- VOLUME DOWN KEY 24
- SCREEN KEY 24
- ITAD OPERATION 25**
 - Default ITAD Settings 25
 - ITAD Programming Overview 25
 - Selecting Announcement (OGM1 & OGM2) 25
 - Recording / Playing / Deleting the OGM's* 25
 - Set Security Code 26
 - Set Audible Message Alert 26
 - Day and Time Setup 27
 - Set Incoming Message Length 27
 - Set Number of Rings 28
 - Leaving a Message 28
 - Recording a Memo 28
 - Listening to Messages / Memos 29
 - Saving Messages 29
 - Deleting Messages 29
 - Scan Playing Messages 30
 - Turning the ITAD ON/OFF 30
 - Call Screening 31
 - Audible Current Day and Time 31
 - Changing Speaker Volume 31
 - Changing Playback Speed 31
 - Auto Disconnect for Extension Phone Pick-up.. 32
 - Memory Full 32
 - Power Failure 32
- REMOTE OPERATION OF ITAD 33**
 - To Activate Remote Operation From a Different Telephone Line 33
 - Playing Messages Remotely 33
 - Scan Playing Messages Remotely 33
 - Repeat Messages During Playback 33
 - Skip Messages During Playback 33
 - Stop Message Playback 33
 - Deleting Messages 33
 - Memo Recording 34
 - Change OGM1 Remotely 34
 - Check OGM1 Remotely 34
 - Turning ITAD On or OFF 34
 - Room Monitoring 34
 - Voice Menu for Remote Operation 34
 - Exiting Remote Operation 35
- MAINTENANCE 36**
- IN CASE OF DIFFICULTY 37**
- WARRANTY STATEMENT 39**
- FCC REGULATIONS 40**
- TECHNICAL SPECIFICATIONS 42**



INTRODUCTION

Congratulations! You have purchased one of the best performing cordless telephones on the market! The **VTECH 914 ADLi** is a single line 900 MHz cordless phone.

The **VTECH 914 ADLi** has automatic security code reset. This means that one of more than 65 thousand possible digital security codes is randomly selected every time the handset is placed in the base unit. The handset and base unit will recognize each other based on this security code which minimizes the chances of another cordless phone using your telephone line. The base unit stores the current security code and channel in memory even if the unit is unplugged.

The VTECH 914 ADLi base unit includes an Integrated Telephone Answering Device (ITAD). The ITAD uses digital memory to record messages, eliminating the need for cassette tapes. You can access your messages from the base unit, or from a remote location. All programming and remote operation functions are guided by a voice menu system.

Other special features are:

- 10 Number Speed Dial Memory
- 10 Channels of operation
- Automatic Search for Available Channel
- Manual Channel Change on Handset
- PAGE from Base to Handset
- REDIAL feature
- Programmable Ringer Types
- Low Battery Detect and Warning indicator
- Hearing Aid Compatible Receiver
- Easy answer - when the phone rings simply press any key on the

- handset to answer (except OFF).
- Removable battery pack
- Extra Battery Charger in the base unit
- Touch Tone and Pulse Dialing
- Temporary Tone Mode

ITAD Features:

- Up to 12 minutes recording time.
- Voice menu for local or remote operation.
- Day and time stamp for incoming messages.
- Auto disconnect stops ITAD from answering call when an extension is picked up.
- Variable speed message playback.
- Selective message delete allows you to keep important messages.
- Message length control; stops recording after 7 seconds of silence.
- Messages and ITAD settings will be retained even after power failure.
- Ring pick-up selection; unit can be set to pick-up after 2 rings, 4 rings, 6 rings or Toll-saver.
- Call screening selection.
- Message scan available.
- Room monitoring option for remote operation.
- Memo recording capability.
- Programmable security code for remote operation.
- Volume control with 4 levels for the ITAD speaker.
- 3 individual and 1 public mailbox for personalized message storage and retrieval.

This manual is designed to familiarize you with the **VTECH 914 ADLi**. To get the most use out of your **VTECH 914 ADLi**, we strongly recommend you read the manual before using your phone.



INTRODUCTION

Parts Check List:

1. Handset
2. Base unit
3. AC adapter
4. Telephone line cord
5. Battery pack
6. Wall mounting bracket

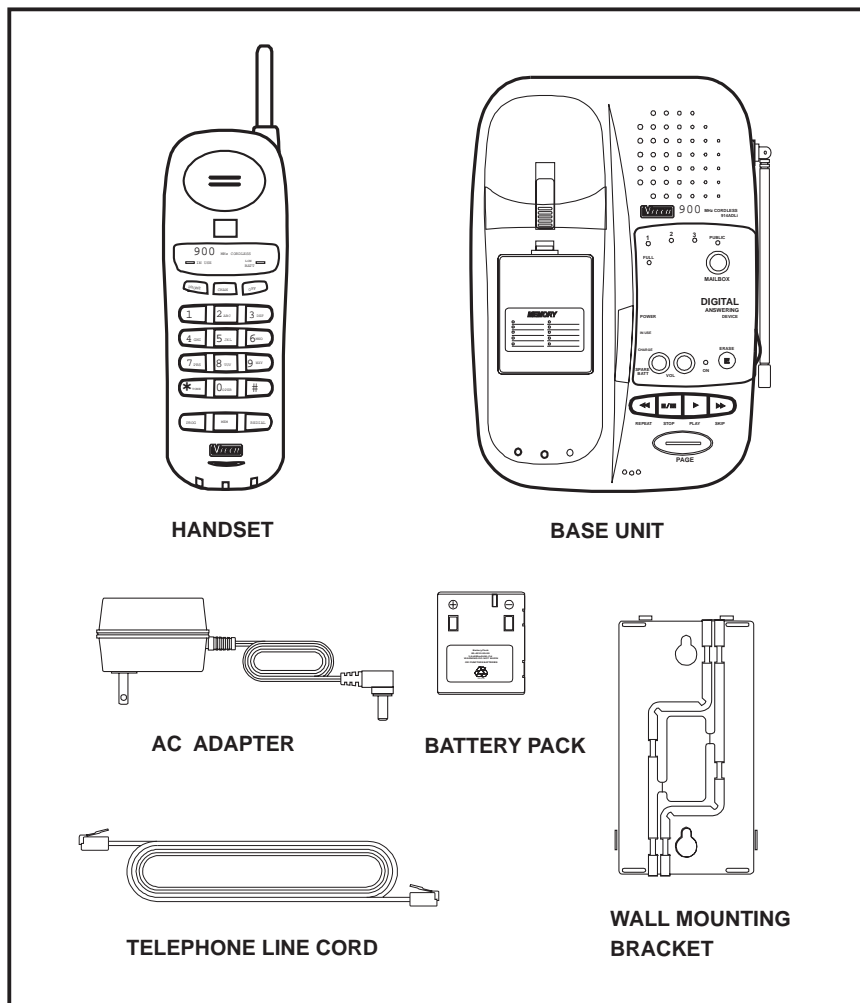



IMPORTANT SAFETY INSTRUCTIONS

When using your telephone equipment, basic safety precautions should always be followed to reduce the risk of fire, electric shock and injury to persons, including the following:

1. Read and understand all instructions.
2. Follow all warnings and instructions marked on the product.
3. Unplug this product from the wall outlet before cleaning. Do not use liquid cleaners or aerosol cleaners. Use a damp cloth for cleaning.
4. Do not use this product near water (for example, near a bath tub, kitchen sink, or swimming pool).
5. Do not place this product on an unstable cart, stand, or table. The product may fall, causing serious damage to the product.
6. Slots and openings in the cabinet and the back or bottom are provided for ventilation. To protect it from overheating, these openings must not be blocked by placing the product on the bed, sofa, rug, or other similar surface. This product should never be placed near or over a radiator or heat register. This product should not be placed in a built-in installation where proper ventilation is not provided.
7. This product should be operated only from the type of power source indicated on the marking label. If you are not sure of the type of power supply to your home, consult your dealer or local power company.
8. Do not allow anything to rest on the power cord. Do not locate this product where the cord will be abused by persons walking on it.
9. Never push objects of any kind into this product through cabinet slots as they may touch dangerous voltage points or short out parts that could result in a risk of fire or electric shock. Never spill liquid of any kind on the product.
10. To reduce the risk of electric shock, do not disassemble this product. If service or repair work is required, contact VTech Customer Service at 1-800-624-5688. Opening or removing cabinet parts other than specified access doors may expose you to dangerous voltages or other risks. Incorrect reassembling can cause electric shock when the appliance is subsequently used.
11. Do not overload wall outlets and extension cords as this can result in the risk of fire or electric shock.

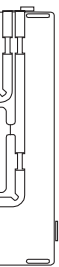

OUNTING
T



IMPORTANT SAFETY INSTRUCTIONS

12. Unplug this product from the wall outlet :
 - A. When the power supply cord or plug is damaged or frayed.
 - B. If liquid has been spilled into the product.
 - C. If the product has been exposed to rain or water.
 - D. If the product does not operate normally by following the operating instructions. Adjust only those controls that are covered by the operating instructions because improper adjustment of other controls may result in damage and will often require extensive work to restore the product to normal operation.
 - E. If the product has been dropped and the cabinet has been damaged.
 - F. If the product exhibits a distinct change in performance.
13. Avoid using a telephone (other than a cordless type) during an electrical storm. There may be a remote risk of electric shock from lightning.
14. Do not use the telephone to report a gas leak in the vicinity of the leak.

SAVE THESE INSTRUCTIONS



REPLACING THE HANDSET BATTERIES

1. Remove the battery case by pressing on the ridged lines and sliding downward.

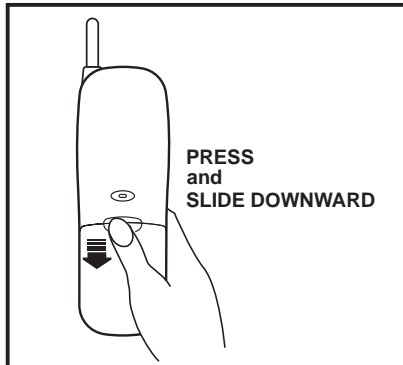

2. Discard the old battery pack. Don't put the old battery pack in a trash compactor or a fire - it could burst.

IMPORTANT: Do not dispose of this battery in household garbage. For information on recycling or proper disposal, consult your local solid waste collection or disposal organization.

3. Place the new battery pack in the battery compartment. Make sure the metal contacts on the underside of the battery are aligned with charging contacts in battery compartment. Replace battery case cover.

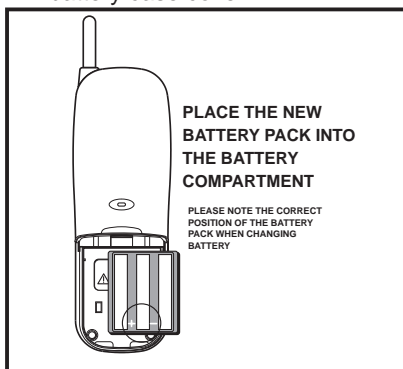

4. The new battery pack must be charged before using your telephone. Place the handset in the cradle of the base unit to allow it to charge for 24 hours. Maximum battery life between charges is 7 hours of continuous talk time or 6 days of standby.

CAUTION: To reduce the Risk of Fire or Injury to Persons, Read and Follow these Instructions:

1. Use only VTECH battery.
2. Do not open or mutilate the battery. Released electrolyte is corrosive and may cause damage to the eyes or skin. It may be toxic if swallowed.
3. Exercise care in handling batteries in order not to short the battery with conducting materials such as rings, bracelets, and keys. The battery or conductor may overheat and cause burns.
4. Do not dispose of the battery in a fire. The cell may explode.

IF THE BATTERY PACK DOESN'T RECHARGE

The battery pack can be recharged many times; but if you get a low-battery signal, or the handset seems completely dead, even after 24 hours of charging, the battery pack should be replaced.

To purchase replacement battery packs, use the enclosed order form, or call Vtech Communications at 1-800-624-5688.



REPLACING THE HANDSET BATTERIES

SPARE BATTERY CHARGER

Your VTech 914 ADLi is equipped with a spare battery charger built-in to the base unit. The spare battery charger allows you to always have a charged battery available, should your handset battery discharge during normal use.

Contact your local VTech dealer, or call VTech Customer Service to purchase a spare battery pack.

To install the Spare Battery Pack:

1. Open the base unit battery compartment.
2. Place the spare battery pack in the battery compartment. Make sure the metal contacts on the underside of the battery are aligned with charging contacts in battery compartment.
3. Replace the battery compartment cover.
4. When the battery is installed properly, the spare battery LED on the base unit will be illuminated.
5. The spare battery will be fully charged after 24 hrs. Please note that the spare battery LED will always be illuminated when a spare battery is installed.



GETTING STARTED

Setting Up Your VTECH 914 ADLi

1. Choose an area near an electrical outlet and a telephone wall jack.

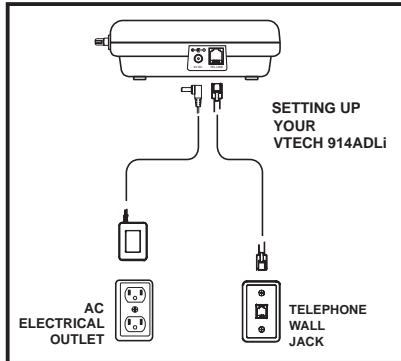

2. Connect the telephone line cord. Insert one end of the telephone line cord into the jack at the rear of the base unit. Plug the other end into a telephone wall jack. Make sure the plugs snap securely into place.
3. Plug the AC power adapter into an electrical outlet and the DC connector to the back of the base unit.

CAUTION: Use only the AC adapter shipped with your 914 ADLi. This is a Class 2 AC adapter, specifically designed for use with the 914 ADLi.

NOTE: Connect power to the base unit before placing the handset in the cradle.

4. The **FULL** and **ON** LED will flash to indicate the ITAD needs to be initialized. After a while, only the **MEM FULL/SET CLOCK** LED flashes, indicating that the day and time must be set.

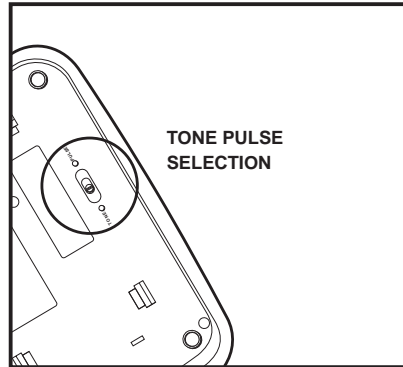

5. Set the **TONE/PULSE** switch on the base unit. If you have touch tone service on your phone line, set the switch to **TONE**. If you have rotary service, set the switch to **PULSE**.
6. **CHARGE THE HANDSET BATTERIES BEFORE USE.** The batteries recharge automatically whenever the handset is in the base unit cradle. The batteries must be charged for **24 hours** before using your phone for the first time. After the initial charge, a maintenance charge of 8 hours is sufficient to return a low battery to full condition.
7. **CHECK FOR A DIAL TONE.** After the batteries are charged, pick up the handset and press the **PHONE** key. The **PHONE** indicator should light up, and you should hear a dial tone. If not, see **IN CASE OF DIFFICULTY**.



GETTING STARTED

CAUTION:

1. Never install telephone wiring during a lightning storm.
2. Never install telephone jacks in wet locations unless the jack is specifically designed for wet locations.
3. Never touch uninsulated telephone wires or terminals unless the telephone line has been disconnected at the network interface.
4. Use caution when installing or modifying telephone lines.





WALL MOUNTING

- 1. Choose a spot near an electrical outlet and a telephone jack.** Your phone requires a modular telephone jack and a standard electrical outlet (120v AC). The power cord is six feet long; make sure there is an electrical outlet within reach of the base. The outlet should not be controlled by a wall switch. If the switch is ever turned off, the phone will not operate.

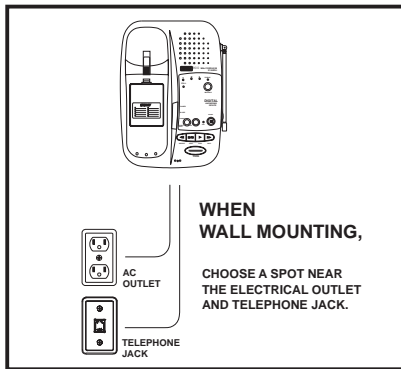

- 2. Position the wall mount adapter on the base.** Line up the tabs on the wall mount adapter with the holes on the bottom of the base. Snap the wall mount adapter firmly in place.

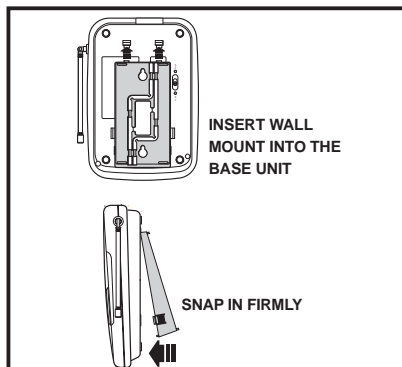

- 3. Mount the base on the wall.** Position the base so the mounting studs will fit into the holes on the bottom of the base. Position the power cord to extend down the wall the phone is to be mounted on. Slide the base down on the mounting studs until it locks into place.

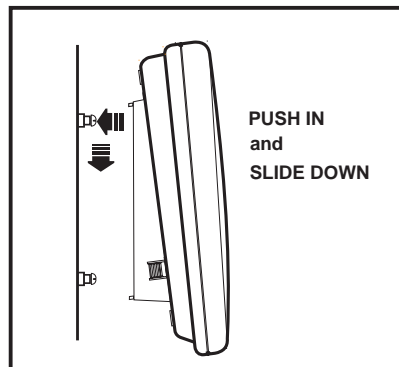

- 4. Connect the telephone cord.** The telephone line cord has a snap-in plug at each end. Insert one of the plugs into the jack on the bottom of the base. Insert the other end of the plug into the wall jack.

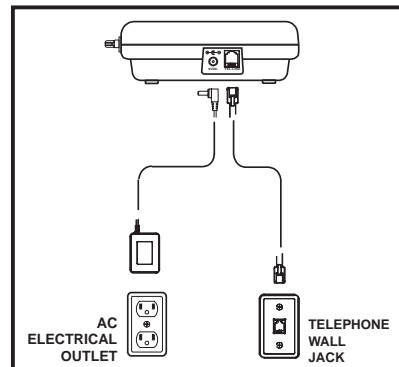



WALL MOUNTING

5. **Plug the AC adapter on the power cord into an electrical outlet.**
6. **Set the dial mode switch on the base unit.** If you have touch tone service on your phone line, set the switch to TONE. If you have rotary service, set the switch to PULSE.

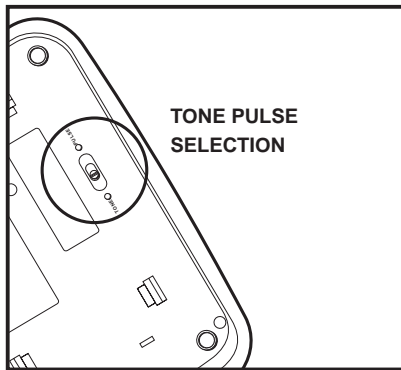



HANDSET FEATURES



IN USE LED

- The **IN USE** LED lights when the phone line is being used by the handset.
- It flashes in cadence with an incoming ring.
- It flashes quickly during PROGRAM mode.

LOW BATTERY LED

- The **LOW BATT** LED will flash when the handset battery is getting low and needs to be recharged.

PHONE KEY / FLASH FUNCTION

- Press the **PHONE** key to make a call.
- If you are currently on a call pressing **PHONE** flashes the line. This would be used with a feature like call waiting to answer your second call.

CHANNEL KEY

- Pressing the **CHAN** key when the handset is in use will activate a channel change to the next free channel.
- This is used if you are experiencing noise or interference on the current channel.

OFF KEY

- Press the **OFF** key to exit all modes of operation.

MEM KEY

- Press the **MEM** key to enter MEMORY mode.
- The sequence for dialing out a speed dial number in memory is: **PHONE**, **MEM**, Number Button (**0-9**).

PROG KEY

- Press **PROG** key to enter PROGRAM mode. See **Programming Speed Dial Numbers** for more details.

REDIAL KEY

- When you hear the dial tone, pressing the **REDIAL** key will dial out the last number that was called on your phone.
- It can also be used to store the last number dialed into the speed dial memory. See **Storing a Redial Number into Speed Dial** for details.

TONE / KEY

- In **PULSE** dialing mode, this key is used to switch to Temporary TONE dialing mode.

VOLUME CONTROL

- Set Volume switch on the side of the Handset to high (H) or low (L), depending on your preference.



BASE UNIT FEATURES

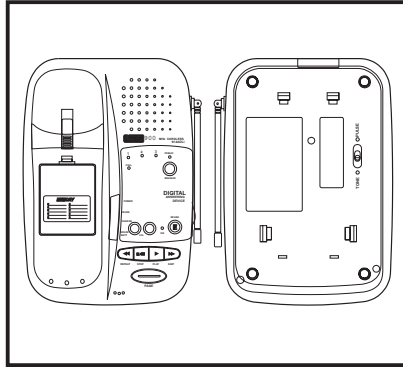

POWER LED

- The **POWER** LED illuminates when the base power adapter is plugged in and power is applied to the base unit.

CHARGE LED

- The **CHARGE** LED illuminates steadily when the handset is in the base cradle to indicate that the handset battery is being charged.

IN USE LED

- Immediately after placing the handset in the base cradle, the **IN USE** LED flashes to indicate that the initialization (assigning a new security code and channel) is in progress
- The **IN USE** LED will stop flashing and stay on when the initialization is complete.
- The **IN USE** LED illuminates whenever the handset is being used.
- The LED also flashes with the cadence of the incoming ring.

SPARE BATTERY LED

- The **SPARE BATT** LED illuminates steadily when a battery is placed in the base unit charge cradle.

PAGE KEY

- Press the **PAGE** key to page the handset.
- Press it a second time to cancel a page.
- The base will ring the handset 4 times before ending the page automatically.
- The handset can also cancel the page by pressing the **OFF** key.

TONE/PULSE SWITCH

- This switch will switch the phone between **TONE** dialing and **PULSE** dialing.



OPERATING INSTRUCTIONS

IMPORTANT: Whenever the handset batteries are removed, the handset must be reinitialized on the base unit cradle after the batteries are replaced. The **IN USE** LED on the base unit will flash during the initialization.

Making Calls

Pick up the handset and press **PHONE**. When you hear a dial tone, dial the number. The indicator for **IN USE** (on the base unit and handset) will light.



If you make a mistake when dialing, press **OFF** to hang up, then press **PHONE** to get the dial tone again.

You must always press **PHONE** before you can dial a call on the handset.

Answering Calls

When an incoming call is ringing, the **IN USE** LED in the base and the **IN USE** LED in the handset will flash. To make sure your phone rings when the handset is away from the base, please keep the base antenna in the upright position.

To answer a call when the handset is in the base, just pick up the handset. To answer a call when the handset is

away from the base, just press any key on the handset (except **OFF**). This is very useful in a dark environment; you do not have to fumble around looking for the **PHONE** key to answer the call.

Disconnecting

To end a call, either place the handset back in the base, or press **OFF** on the handset.

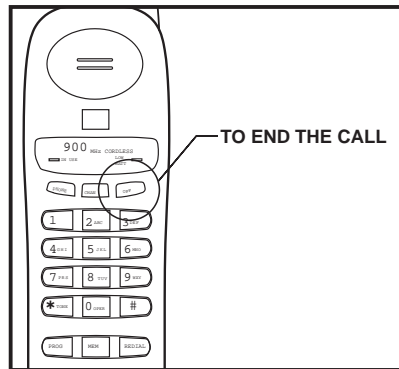

Changing Channels

If you notice interference when using your handset, press **CHAN** to switch to a clear channel. This function is only available when you are on a call.

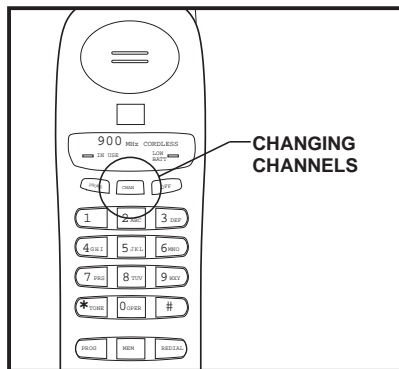



OPERATING INSTRUCTIONS

Temporary Tone

If you have a rotary (dial-pulse) telephone service, (**TONE/PULSE** switch is set to **PULSE**), this feature allows you to enter special codes and tones to operate answering machines, use electronic banking services, calling cards, or other special services.

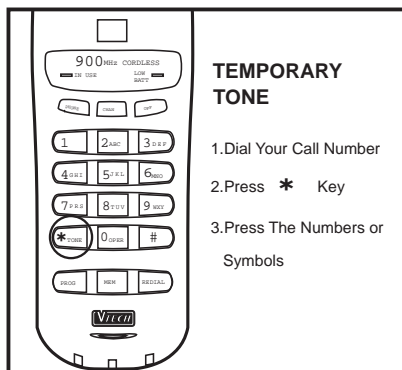

First, dial the call normally. Then activate the Temporary Tone feature by pressing **TONE** (the * key). You can then press the numbers or symbols you need, and your phone will send the proper signals.

To end the call, press **OFF** or place the handset back in the base. The phone will automatically go back to rotary (dial-pulse) service.

If you have touch-tone service, (**TONE/PULSE** switch set to **TONE**), just enter the codes normally. This feature is only for rotary service telephone lines.

Programming The Ringer Type

The handset ringer is capable of four different types of ringing tones. The following sections detail how to change the different tones and to turn off a ringer on the handset.

To program, the handset must be **OFF**.

To select a different ringer type do the following:

- Press **PROG**
- Press the **#** key.
- Press a key **1..4** to select a ringer type.
- Press the **OFF** key to exit.

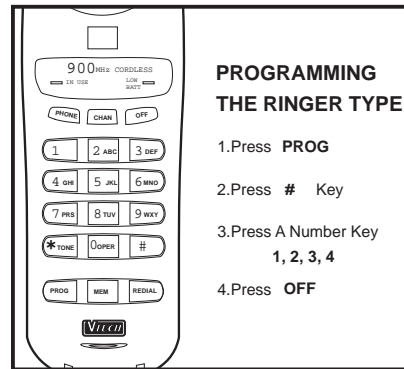

Turning Off The Ringer

To turn off the ringer on the handset, do the following:

- Press **PROG**
- Press the **#** key
- Press **5** to turn off the ringer
- Press the **OFF** key to exit
- To turn ringer on again, see **Programming the Ringer Type**.

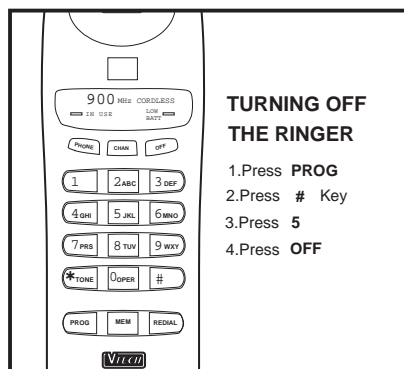



OPERATING INSTRUCTIONS

Checking The Ringer

To check the ringer which is currently programmed, do the following:

- Press **PROG**
- Press the **#** key
- Press **0**
- Press the **OFF** key to exit

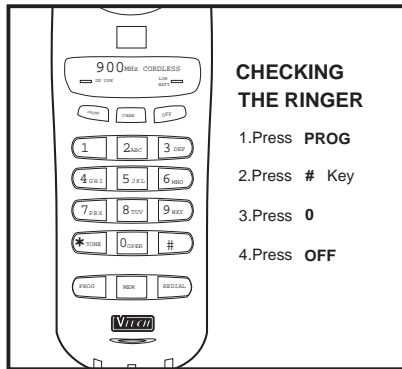

2. Press the number of the memory location you wish to store the number in (**0-9**).
3. Using the dial pad, dial the number you want to store. The number can be up to 16 digits long. The number can be entered manually or by using **REDIAL**.
4. Press **MEM** to store the phone number to the key you selected.

The phone now exits **PROG** mode and emits a tone.

Speed Number Dialing

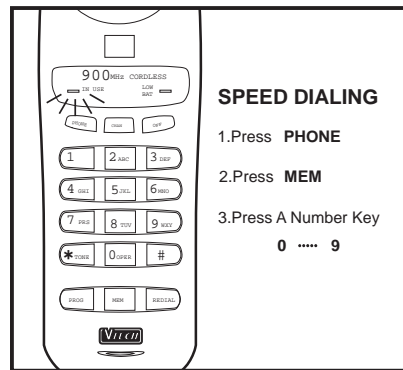

1. Press **PHONE** to get a dial tone.
2. Press **MEM** and the memory location number key (**0-9**).

For example, to dial the number you assigned to key '8', you would press **PHONE, MEM, 8**.

Memory Dialing

The **VTECH 914 ADLi** can store up to 10 different phone numbers that you can dial just by pressing **MEM** and one of the number keys (**0-9**).

Programming Speed Dial Numbers

The handset must be **OFF**.

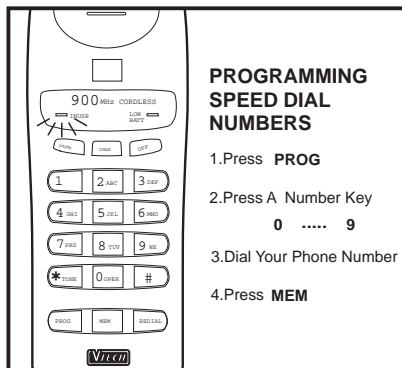

1. Press **PROG**. The **IN USE** LED will blink to indicate that you are in the programming mode.

To Change or Replace a Speed Dial Number

To change or replace a stored number in speed dial simply enter the new number and store it in the memory location you wish to change.





OPERATING INSTRUCTIONS

For example, to change the number stored in memory position 7 to 555-1111, you would press **PROG**, **7**, **555-1111**, **MEM**.

Storing Special Codes

To insert a pause in a phone number, press and hold the number before the position where the pause is to be inserted. Hold the number key down until it beeps twice. The pause is 2 seconds in length. For longer pauses, press and hold the key until it beeps for three or four times. Each additional beep indicates an additional 2 second pause.

If your phone is connected to a PBX you can store the PBX access number and a pause before the phone number. For example, to store **9-PAUSE-555-1234** in memory location **8**, do the following:

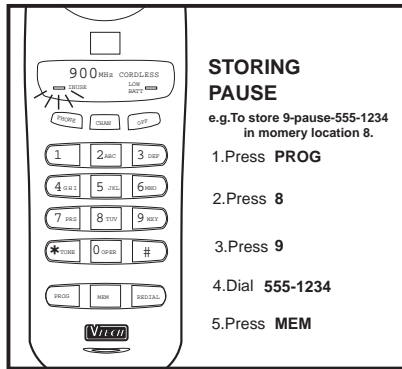

1. Press **PROG**
2. Press **8**
3. Press and hold **9** until it beeps at least twice.
4. Dial **555-1234**
5. Press **MEM**

Using Redial

To **REDIAL** the last number you called, press **PHONE** then press **REDIAL**. The phone will automatically dial the number.

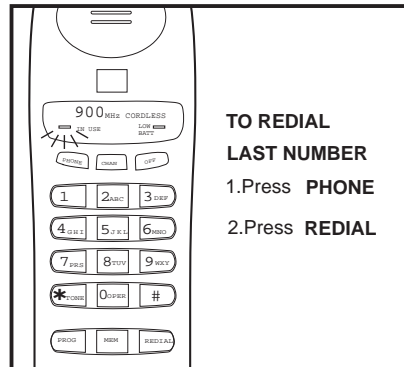

Storing a Redial Number into Speed Dial

To store the last number you dialed as a regular Speed Dial number, press **PROG**, a number key (**0-9**), **REDIAL**, **MEM**.

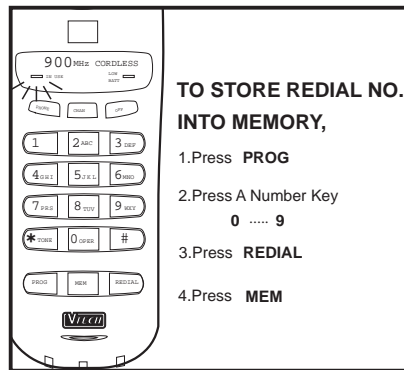



OPERATING INSTRUCTIONS

The Page Feature

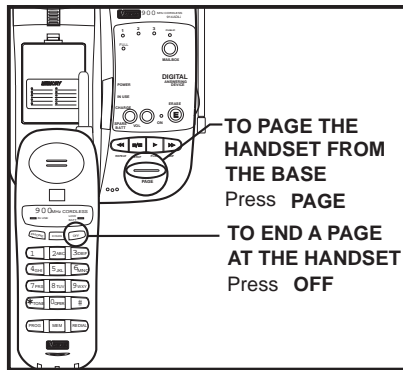

From the base unit, press **PAGE** to signal the person at the handset. To end the page at the base, press **PAGE** again. To end the page at the handset, press **OFF**.

This feature is also useful if you have misplaced the handset. To locate the handset press **PAGE** at the base. This starts a paging tone at the handset. When it is located cancel the paging tone by pressing **OFF** on the handset.



ITAD BASE LEDS

MAILBOX LED'S

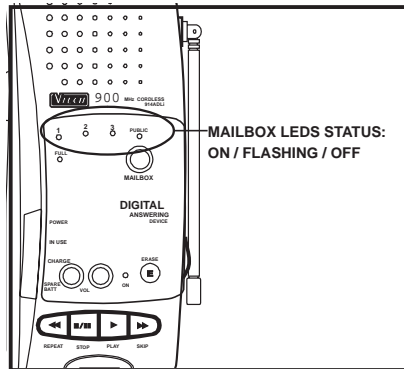

The MAILBOX LED's (1,2,3 and Public) indicate the status of messages in each mailbox . Upon receiving new messages, the corresponding MAILBOX LED's will flash indicating that new messages are waiting. The MAILBOX LED remains on steadily if there are old messages inside a particular mailbox. Otherwise the MAILBOX LED remains off when no messages are present.

- ON LED will flashes to indicate answering a call, in recording mode, in memu program mode or the system in busy.

FULL LED

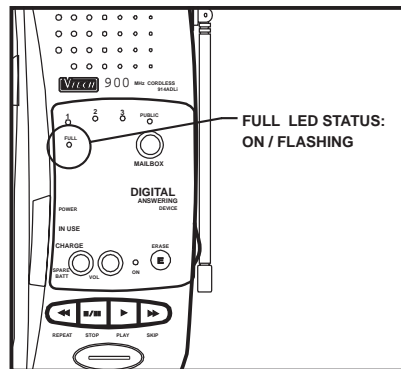

- FULL LED flashes after a power failure to indicate the day and time needs to be set again.
- FULL LED remains on steadily when less than 30 seconds recording memory remains.

ON LED

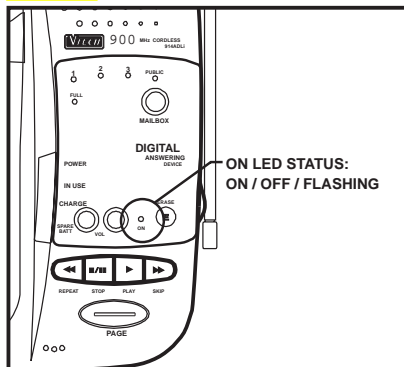

- ON LED will remain off if ITAD is not in auto-answer mode.
- ON LED remains on steadily when ITAD is in auto-answer mode.



ITAD BASE KEYPAD FUNCTIONS

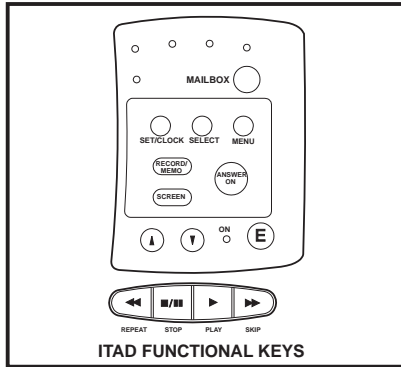

- Use the MAILBOX key to select the desired mailbox, either for message/memo playback or for memo recording.
- MAILBOX “name” is announced during the current mailbox selection. Each press of the MAILBOX key selects the next mailbox option in the following order: 1>2>3>Public>1>2....
- If the MAILBOX key is not pressed for 4 seconds, the ITAD will return to normal operation mode, and the default selection is Public Mailbox.

ANSWER ON KEY

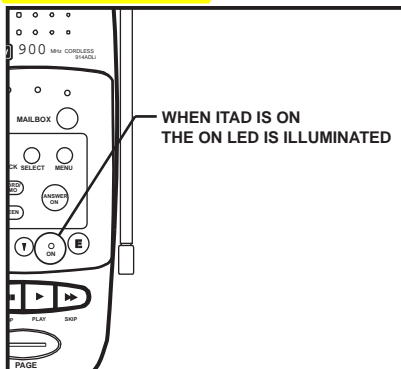

- This key is used to turn ON and OFF the ITAD. While in the OFF mode, the cordless phone will still operate normally, but will not answer calls.
- When the ITAD is ON, the ON LED is on.
- Regardless of whether the ITAD is ON or OFF, the MAILBOX LED's and the FULL LED are still functioning.
- When OFF, the ITAD can be reactivated remotely by 10 successive rings on an incoming call.

MAILBOX KEY

- The ITAD stores the messages into different mailboxes for retrieval by the corresponding mailbox user. For example, Mailbox 1 is for John, Mailbox 2 is for Jane, etc.

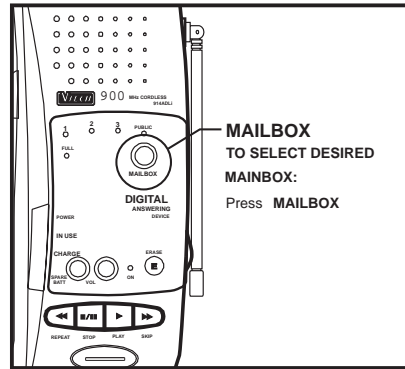

RECORD / MEMO KEY

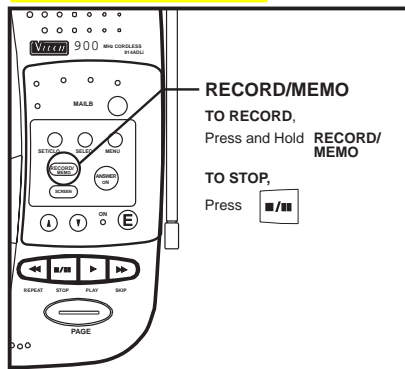

- The RECORD/MEMO key is used to record memos at the base unit into the current selected mailbox. The maximum record time is 1 minute.



ITAD BASE KEYPAD FUNCTIONS

- Press and hold the **RECORD/MEMO** key until you hear, "Now recording". Record your memo.
- Stop recording by pressing the **STOP** key again.
- If you go beyond the 1 minute limit, or if there is 7 seconds of silence, the ITAD will automatically stop and you will hear, "End of recording".
- Pressing **SELECT** again will confirm the current setting or advance to the next setting, if applicable.

MENU KEY

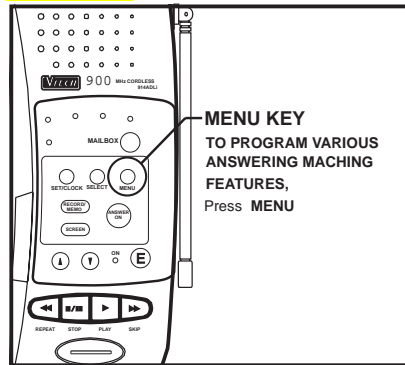

- The **MENU** key is used to program the answering machine. Each time you press **MENU**, the ITAD settings will be announced in the following order:
 - Outgoing Message 1
 - Outgoing Message 2
 - Set Security Code
 - Set Audible Message Alert
 - Set Day and Time
 - Set Incoming Message Length
 - Set Number of Rings

—Program the desired setting when you hear the appropriate voice option. (See ITAD Setup)

SELECT KEY

- After you enter Program Mode, pressing **SELECT** will announce the current setting of the selected menu function.

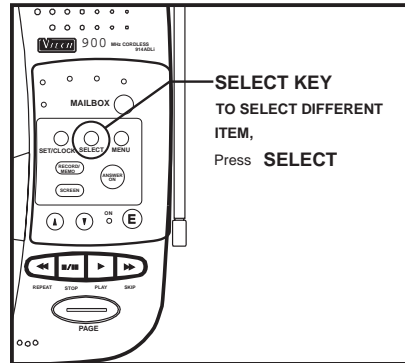

SET/CLOCK KEY

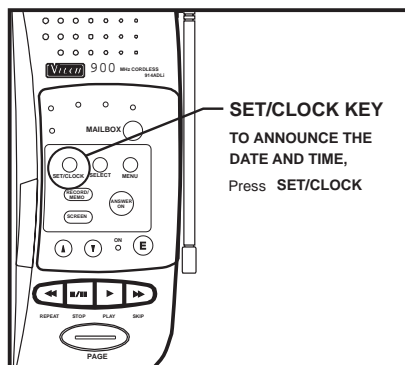

- The **SET/CLOCK** key is used to check the date and time. In normal operation, the day and time are announced when **SET/CLOCK** key is pressed.
- The **SET/CLOCK** key is used to set the current selection in program mode. It is used with the **MENU** and **SELECT** keys. (See ITAD Setup)

PLAY KEY

- The **PLAY** key is used to begin playback of all messages/memos (new and old) in the current mailbox selection (the default mailbox selection is Public).





ITAD BASE KEYPAD FUNCTIONS

- The **PLAY** key is also used to play only the new messages by pressing and holding the key for more than 1 second.

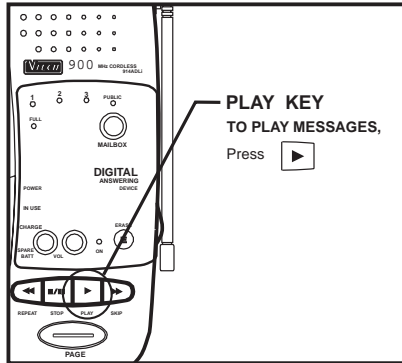

REPEAT KEY

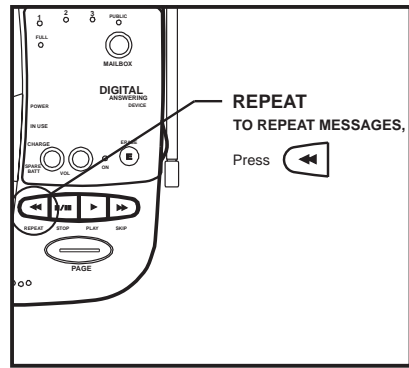

- The ◀◀ key is used to return to the beginning of a message during message playback.
- The previous message will also begin if ◀◀ is pressed twice quickly during message playback.

ERASE KEY

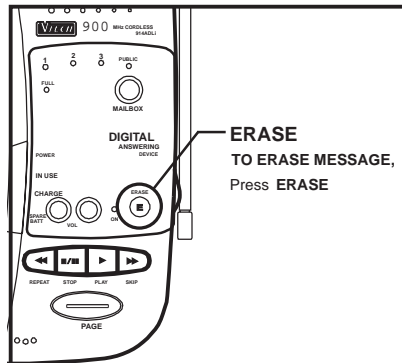

- The **ERASE** key is used to delete old messages (previously reviewed) from the ITAD.
- Pressing **ERASE** during message playback deletes that message.
- If the **ERASE** key is pressed and held for more than 1 second, all old (previously reviewed) messages in the current mailbox selection will be deleted (this feature works only when the answering machine is idle; it does not work during message playback).
- To prevent accidental deletion of new messages, you can only delete previously reviewed message.

STOP KEY

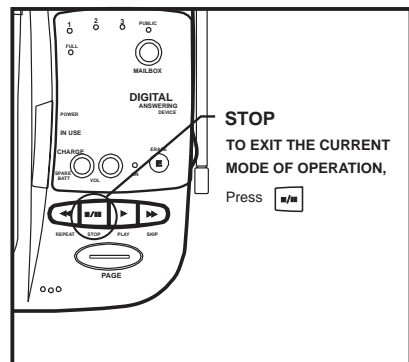

- Use [STOP] to pause message playback. Press [▶] to resume playing from the beginning of the message.
- Note: During message playback, press [STOP] once to pause, press [STOP] twice to stop. If no key is pressed for 60 seconds the ITAD will automatically default to normal operation.
- Press [STOP] to stop memo or announcement recording, or exit the program mode.





ITAD BASE KEYPAD FUNCTIONS

SKIP KEY

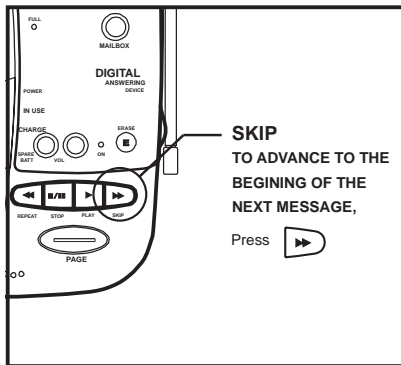

- The ►► key advances to the beginning of the next message during playback.
- ►► is also used to Scan Play all messages with the first 5 seconds playback each, in the current mailbox. To Scan Play only the new messages, press and hold ►► for 1 second.
- Note: Day and time stamp will not be announced during Scan Play.

- During message playback, press and hold ► while pressing ▲ key to increase message playback speed.

VOLUME DOWN KEY

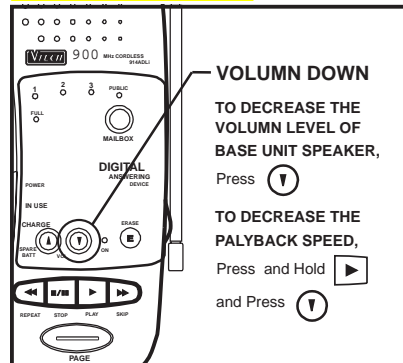

- The ▼ key is used to decrease the volume level of the base unit speaker.
- During message playback, press and hold ► key while pressing ▼ key, to decrease message playback speed.

VOLUME UP KEY

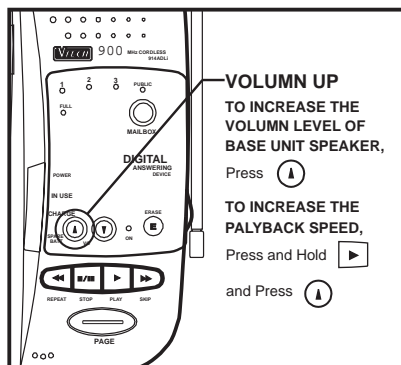

- The ▲ key is used to increase the volume level of the base unit speaker.

SCREEN KEY

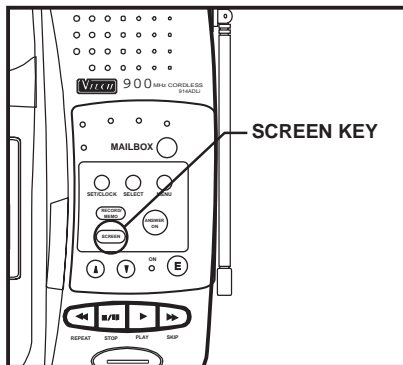

- The **SCREEN** key is used to turn Call Screening ON or OFF.



ITAD OPERATION

Default ITAD Settings

The ITAD is preset to have the following default settings:

- security Code: **19**
- Audible Message Alert: **OFF**
- Date & Time: **Mon 12:00am**
- Incoming Message Length: **60 Seconds**
- Rings to answer: **4**

ITAD Programming Overview

Setup order for the ITAD is:

1. Outgoing Message 1 (OGM1).
2. Outgoing Message 2 (OGM2).
3. Set Security Code
4. Set Audible Message Alert
5. Set Day and Time
6. Set Incoming Message Length
7. Set Number of Rings

Lift the setup control access door on the base unit to program ITAD settings.

During ITAD setup, the **ON** LED will flash. If no key is pressed for 15 seconds, the ITAD will beep and exit PROGRAM mode. You can also exit PROGRAM mode at any time by pressing **■/■**.

Selecting Announcement (OGM1 & OGM2)

There are 2 choices of announcements: Outgoing Message 1 (OGM1) & Outgoing Message 2 (OGM2). Incoming Message Length Setting will determine which OGM will be used. (See **Set Incoming Message Length**).

Outgoing Message 1

You can record your own personal announcement and the caller is able to leave a message.

If you do not record your own announcement the default greeting is:

"Please leave your message after the beep." (See **Recording OGM's**)

Outgoing Message 2

You can record your own announcement, but the caller is not able to leave a message.

If you do not record your own announcement, the factory default greeting is: *"I'm sorry, I'm not available. Please call again."* (See **Recording OGM's**)

Example for OGM's:

Example for OGM1 with Public mailbox only (acts as standard answering machine):

"Hello. You have reached 555-1234. I can't answer the phone right now. Please leave a message after the beep. Thank you."

Example for OGM1 (for multi - user application):

"Hi! We can't come to the phone right now. If you have a message for John press 1, for Jane press 2, for Jack press 3. If you have a message for any one of us, just stay on the line and record after the beep. Thank you."

Example for OGM2 (announce only):

"Hi! You have reached Jack and Jill. We will be back after 1 p.m. Please call back then. Thank you."

Recording / Playing / Deleting the OGM's

1. Press **MENU** key until the desired item (OGM1 or OGM2) is announced.
2. Press **SELECT** to select the desired OGM.
3. Press **RECORD/MEMO**. "Now recording", is announced, followed



ITAD OPERATION

- by a beep. Speak in the direction of the ITAD. You can record an OGM up to 90 seconds in length.
- Press **■/■** to stop recording.
 - After finishing the recording, the OGM replays automatically. At the end of the OGM playback, you will hear a beep.
 - To review a recorded announcement, press the **MENU** key until the desired item (OGM1 or OGM2) is announced. Press **SELECT**. Press **▶**. The current greeting is played.
 - To delete a recorded announcement, press **ERASE** during the playback of the OGM.

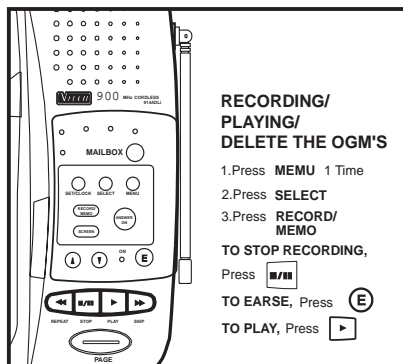

Note: If your recording time is less than 2 second, your OGM will not be recorded, and the default greeting will be used.

Set Security Code

The security code programmed into the ITAD is used to gain access to functions from remote locations.

The security code default setting is 19. To change the security code:

1. Press **MENU** until you hear "Set security code."

2. Press **SELECT**. You will hear an announcement of the current security code.
3. Press **SELECT** briefly to increase the security code by 1. Or, hold the **SELECT** continuously to increase the code by multiples of 10.
4. Press **SET/CLOCK** to confirm your choice and you will hear the announcement of the security code.

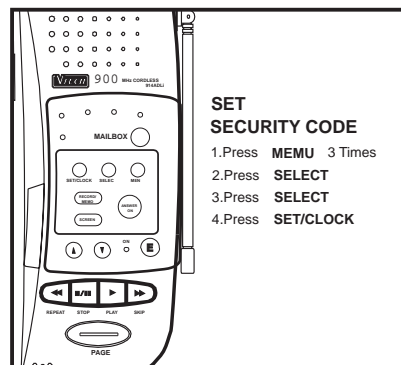

Set Audible Message Alert

If you want your ITAD to beep once every 30 seconds to notify you when new messages have been received, set the Audible Message Alert to ON. Otherwise, it is preset to OFF.

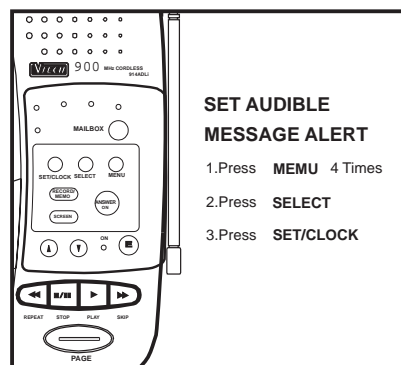



ITAD OPERATION

1. Press **MENU** until you hear "Set audible message alert."
2. Press **SELECT** until the desired setting, (ON or OFF) is announced.
3. Press **SET/CLOCK** to confirm your choice. The voice prompt of "Audible Message Alert On" or "Audible Message Alert Off" will be produced.
6. Press **SELECT** until the desired minute is announced. Holding the **SELECT** key continuously will increase the minute in 10 minute steps.
7. Press **SET/CLOCK** to confirm your choice. You will hear a beep, followed by an announcement of the day and time.

Day and Time Setup

During initial setup, or after a power failure, the day and time default is set to **Monday 12:00am**. The FULL LED will flash to indicate day and time need to be set.

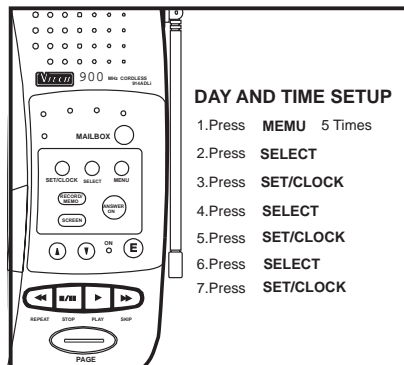

1. Press **MENU** until you hear, "Set day and time."
2. Press **SELECT** until the desired day is announced.
3. Press **SET/CLOCK** to confirm your choice. You will hear a beep followed by an announcement of the current hour setting.
4. Press **SELECT** until the desired hour is announced.
5. Press **SET/CLOCK** to confirm your choice. You will hear a beep followed by an announcement of the current minute setting.

Set Incoming Message Length

The incoming message length can be programmed to 30, 60, or 90 seconds. Also, the ITAD can be set to **Announce Only**; i.e. it does not allow the caller to leave any messages.

To set the Incoming Message Length:

1. Press **MENU** until, "Set incoming message length" is announced.
2. Press **SELECT** until the desired setting - "30 seconds", "60 seconds", "90 seconds", or "announce only" is announced.
3. Press **SET/CLOCK** to confirm the setting. The selected choice will then be announced.
4. If the incoming message is set to 30, 60, or 90 seconds, the ITAD will use OGM1 only.
5. If the incoming message length is set to "announce only", the ITAD will use OGM2 only.

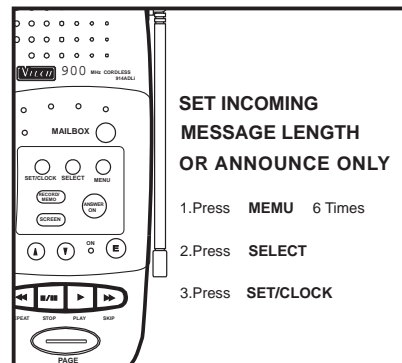



ITAD OPERATION

Set Number of Rings

The ITAD has 4 ring type settings:

- 2 rings The incoming call is answered after 2 rings.
- 4 rings The incoming call is answered after 4 rings.
- 6 rings The incoming call is answered after 6 rings.
- Toll Saver The incoming call is answered after 2 rings only if there are new messages / memos present in the Public mailbox. Otherwise, the ITAD will answer calls after 4 rings. Thus, if Toll Saver is active and your ITAD rings 3 times when you call, you can hang-up to avoid any long distance charges.

3. Press **SET/CLOCK** to confirm your choice. The selected setting is then announced.

Leaving a Message(Incoming Message)

The ITAD will answer a call (according to the current ring selection), play the OGM followed by a beep to signal the start of recording.

- Messages can be a maximum of 90 seconds in length. (See **Setting the Incoming Message Length**) The ITAD will automatically stop recording if there is more than 7 seconds of silence.
- To select a specific destination mailbox for a message, the caller should press the number corresponding to the desired mailbox. For example "1" for mailbox one.
- For the Public mailbox simply stay on the line and record after the beep.

Note: Toll Saver does not function for mailboxes 1, 2, or 3.

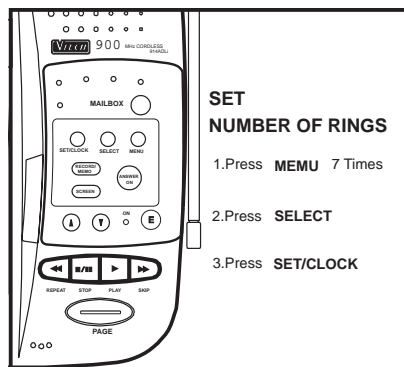

1. Press **MEMU** until you hear "Set number of rings."
2. Press **SELECT** until you hear the desired ring type, "2", "4", "6", or "Toll Saver" announced.

Recording a Memo

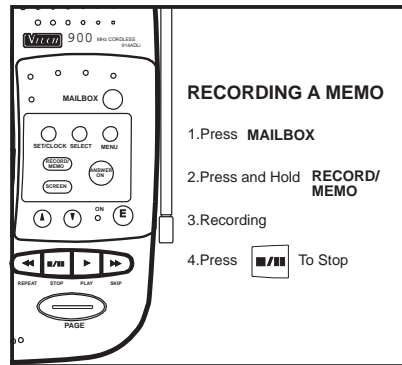

1. Press the **MAILBOX** key to select the mailbox where you want to record the memo.
2. Within 4 seconds, press and hold the **RECORD/MEMO** key until you hear the announcement, "Now recording", followed by a beep.



ITAD OPERATION

3. Speak in the direction of the base to record a memo of up to 60 seconds in length.
4. Press the **RECORD/MEMO** key to stop recording.
5. If time expires or more than 7s silence or memory is full, the ITAD will stop recording automatically.
6. If memory is full, you will hear four beeps and "Memory full" will be announced when you press **RECORD/MEMO**.

Listening to Messages / Memos

When new messages and/or new memos are in the ITAD, the corresponding Mailbox LED's will flash.

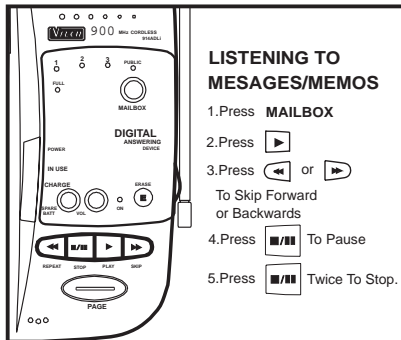

- Press **MAILBOX** to select the desired Mailbox.
- Press **▶** within 4 seconds to playback all the messages. Note that the ITAD will return to the Public Mailbox if **▶** is not pressed within 4 seconds. If you want to play the new messages only, press and hold **▶** for 1 second.
- The ITAD will announce the total number of messages/new messages present in the selected mailbox, depending on how long the **▶** key is pressed.
- The **◀◀** and **▶▶** keys can be used to skip forward and backward during message playback.

- Press **■/■** at any time during message playback to pause. Pressing **▶** will playback the paused message from the beginning. To stop message playback, and return to normal operation mode, press **■/■** again. Note that if the ITAD is left in pause mode for more than 60 seconds, it will automatically go back to normal operation mode, and announce, "End of messages."
- The day and time stamp is announced after each message is played.
- After all messages and memos have been played, the final voice prompt will be, "End of messages", and the ITAD will exit playback mode.
- Pressing **■/■** twice can also exit the playback status.

Saving Messages

- The ITAD will automatically save your messages if you do not delete them. The messages will be retained even after power failure.
- The system can record up to 12 minutes of messages.

Deleting Messages

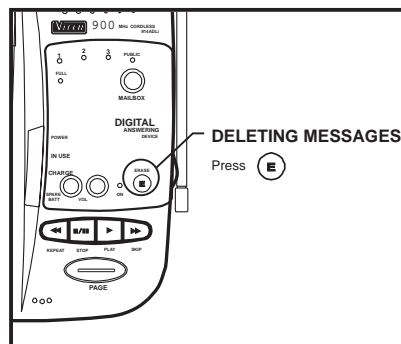

- Press **ERASE** key at any time during message playback or during the corresponding day and time stamp to delete the current message.



ITAD OPERATION

- All reviewed messages for a particular mailbox, can be deleted by pressing and holding the **ERASE** key until you hear, "All old messages deleted."

Note: The ERASE function will only delete old or reviewed messages. New messages CANNOT be deleted until they are reviewed.

Scan Playing Messages

Scan Playing provides a 5 second preview of each message recorded in a particular mailbox. • Press **MAILBOX** until the desired mailbox is announced.

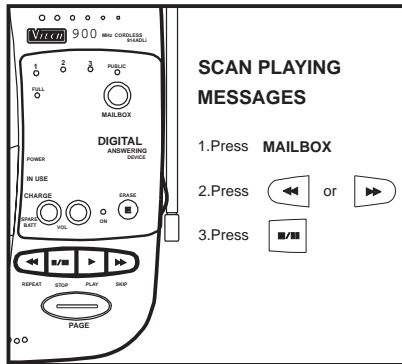

- Press **▶▶** within 4 seconds to Scan Play all the messages. Note that the ITAD will return to the Public mailbox if **▶▶** is not pressed within 4 seconds. If you want to Scan Play the new messages only, press and hold **▶▶** for 1 second.
- The ITAD will announce the total number of messages / new messages present in the selected mailbox.
- Press **■/■** at any time during Scan Play to exit the scanning mode. Pressing **▶** during Scan Play will playback the current message from the beginning. The ITAD will return to normal playback mode.

- The day and time stamp will not be announced after each message is played, while in Scan Play mode.
- Playback speed cannot be adjusted while in Scan Play mode.
- After all messages and memos have been scanned, the final voice prompt will be, "End of messages", and the ITAD will return to normal operation.

Turning the ITAD ON/OFF

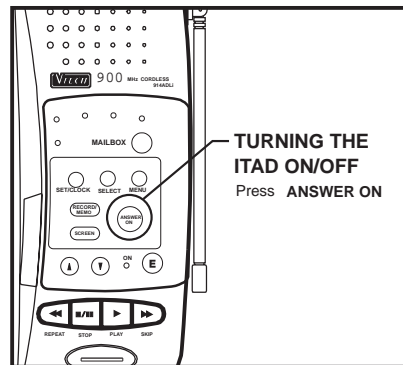

- If you want the ITAD to answer calls, press **ANSWER ON** key. The ON LED will then be turned on and "Answering machine on" will be announced.
- If you don't want the ITAD to answer calls, press **ANSWER ON** key. The ON LED will then be turned off and "Answering machine off" will be announced.
- Even if the ITAD is set to OFF, it will still answer calls after 10 rings. An announcement, "Please enter your security code" is given, and you can enter your security code to use remote operation. (See **Remote Operation of ITAD**)

Note: The ITAD will default to ON after power up.



ITAD OPERATION

Call Screening

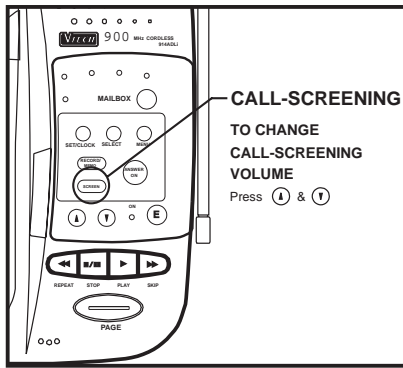

Call screening allows you to listen to incoming messages through the base unit as they are being recorded.

When the ITAD answers a call, the speaker will monitor the voice on the line. If you want to answer the call at once, just pick-up the handset, or an extension, and the ITAD will automatically stop recording.

The Call Screening volume is controlled by the ▲ and ▼ keys. Call Screening can be enabled or disabled by pressing the **SCREEN** key at any time, even when the ITAD is answering a call.

Note: Default setting for Call Screening is ON.

Audible Current Day and Time

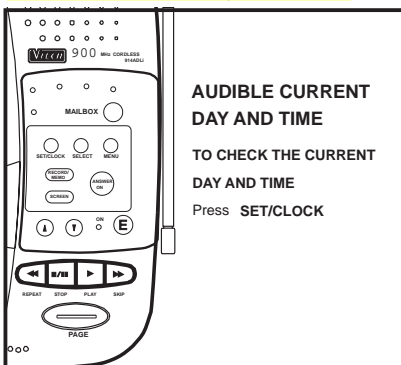

You can check the current day and time by pressing SET/CLOCK. After the announcement the ITAD will generate a double beep.

Changing Speaker Volume

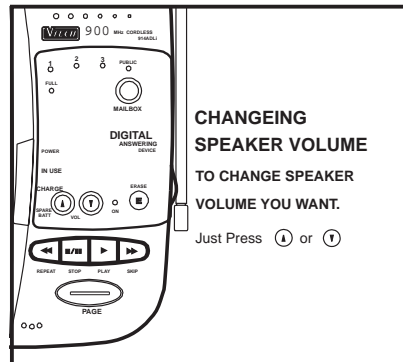

Press the ▲ and ▼ keys to reach the desired volume level. There are 4 digital volume levels.

In idle mode, pressing the volume keys will generate a beep. Four rapid warning beeps will indicate the MAX. or MIN. volume level has been achieved.

Changing Playback Speed

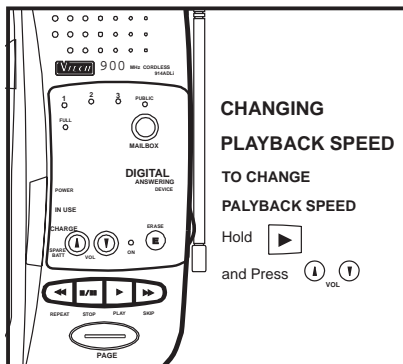

During playback, you can change the playback speed by simply holding



ITAD OPERATION

down ► while pressing ▲ or ▼ to the desired speed.

There are 7 playback speeds. The default speed is normal. Playback speed will return to normal once you exit the playback mode.

Auto Disconnect for Extension Phone Pick-up

The ITAD will auto-disconnect the telephone line if an extension phone or the cordless handset accesses the line.

Note: If the ITAD continues to record after an extension phone or the cordless handset accesses the line, either press ■/■ on the base or press * on the extension phone or cordless handset.

announced. You may enter remote operation mode by entering the security code.

- If memory is full, any attempt to record memos or OGM's will be inhibited.

Power Failure

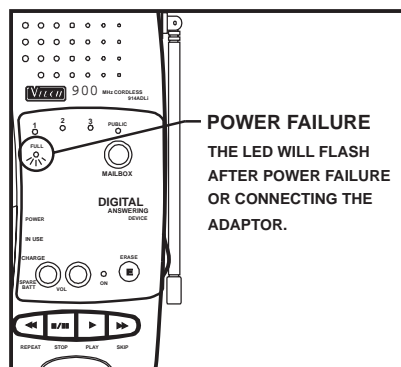

- After a power failure, the FULL LED will flash to notify you to set the day and time.
- All the messages, OGM's and menu settings (other than day and time) will be retained.
- The ITAD will default to ANSWER ON and Call Screening ON.
- Note that after power up, the ITAD will have an initialization period, during which, the ON and FULL LEDs will flash. During this period, you can still use the cordless phone.

Memory Full

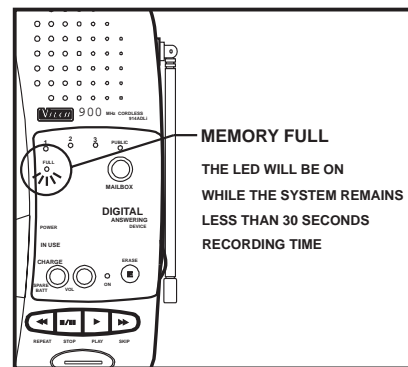

- When the ITAD has less than 30 seconds recording time remaining, the FULL LED will be illuminated.
- If the ITAD memory is full, it will automatically default to ANSWER OFF mode. The ITAD will answer a call after 10 rings and "Memory full, Please enter your security code" is



REMOTE OPERATION OF ITAD

Remote operation allows you to control the functions of the ITAD when you are away from the base, and call from an outside telephone line. The ITAD cannot be accessed from another telephone on the same line. You can access many of the ITAD functions from a remote location such as listening to messages, changing recorded announcements, and recording memos.

Remote operation can only be accessed from a touch tone telephone. If the remote phone is set to pulse dialing, switch it tone. If tone dialing is not available you will not be able to access the ITAD.

To Activate Remote Operation From a Different Telephone Line

1. If the ITAD is off, you can dial your telephone number and wait for the ITAD to answer your call after 10 rings. An announcement, "Please enter your security code" is given, and you can enter your security code to use remote operations.
2. If the ITAD is on, it will answer your call and begin playing the currently selected announcement (as with any incoming call).
3. Enter # followed by your 2 digit security code during the announcement. **The default security code is 19.**
4. Once the security code is received, a double confirmation beep will be given and you are in Remote Operation mode. You can then control the ITAD functions using the telephone keypad. If no command is received for 4 seconds, the ITAD will playback the new messages in the Public mailbox.

Playing Messages Remotely

- For the Public mailbox, press "5" on the touch tone keypad to play your messages. To play new messages only, press "5" twice.
- If you want to play messages in other mailboxes, press 8 until the desired mailbox number ("Mailbox 1", "Mailbox 2",...etc.) is announced. Then press "5" or "5" twice (for new messages only) to playback the messages in the selected mailbox.

Scan Playing Messages Remotely

1. Select the mailbox by pressing "8", then press "6" on the touch tone keypad to Scan Play your messages. To Scan Play new messages only, press "6" twice.
2. Pressing "5" during a message will enter the normal playback mode and the current message will be played again, from the beginning of the message.

Repeat Messages During Playback

1. Press "4" once during message playback to repeat the current message.
2. Press "4" twice within 1 second to skip to the previous message.

Skip Messages During Playback

1. Press "6" once to skip forward to the next message

Stop Message Playback

1. Pressing "0" during message playback will stop playback. The ITAD will accept other remote commands.

Deleting Messages

1. Press "3" once during message playback to delete the current message.



REMOTE OPERATION OF ITAD

- To delete all the old messages in a mailbox, while in idle mode, select the desired mailbox first by pressing “8”. Then press “3” twice on the touch tone keypad. You will hear the announcement, “All messages deleted”, followed by a double beep to confirm your action.

NOTE: Pressing “3” twice while playing messages may result in the deletion of a previously unplayed message.

Memo Recording

- Press “8” to select the desired mailbox.
- Enter “2” twice on the touch tone keypad to record a memo. You will hear, “Now recording”, followed by a beep to signal start of recording.
- Enter “0” to stop recording when you have finished.

Change OGM1 Remotely

- Enter “1” then “2” to record a new OGM1. You will hear, “Now recording”, followed by a beep to signal start of recording.
- Press “0” to stop recording. Your new OGM1 will playback automatically, followed by a double beep.

Check OGM1 Remotely

Enter “1” twice to review OGM1. You will hear playback of OGM1 followed by a double beep.

Turning ITAD On or OFF

Pressing “7” toggles the ITAD ON/OFF. “Answer machine on”, or “Answer machine off” will be announced, followed by a double beep.

Room Monitoring

Room monitoring allows you to hear what is happening inside the room, while you are away.

To perform Room monitoring:

- Press “9”, the microphone on the ITAD will be activated for 20 seconds for room monitoring.
- After 20 seconds has gone by, or when you press “0”, the ITAD will exit room monitoring operation.

Voice Menu for Remote Operation

The system provides two pre-recorded voice menus to help you during remote operation. Press “#”, and you will hear the simple voice menu. Press “#” again and you will hear the advanced functions menu.

The simple voice menu is as follows:

- Press “5” to play all messages
- Press “4” to repeat the message
- Press “6” to skip or scan the message
- Press “3” to delete the message
- Press “8” to select a mailbox
- Press “#” for other functions



REMOTE OPERATION OF ITAD

The advanced functions voice menu is as follows:

- Press “1” twice to review outgoing message 1
- Press “1” then “2” to record outgoing message 1
- Press “2” twice to record memo
- Press “3” twice to delete all old messages
- Press “4” twice to repeat previous message
- Press “5” twice to play all new messages
- Press “7” to turn the system ON or OFF
- Press “9” to start room monitoring

Pressing any function code will stop the voice menu, and perform the corresponding functions.

Exiting Remote Operation

1. Enter “ * ” on the touch tone keypad to exit remote operation mode. The ITAD confirms your action with four beeps and then disconnects.
2. The ITAD also automatically disconnects if no key is pressed within 15 seconds during remote operation.





MAINTENANCE

TAKING CARE OF YOUR TELEPHONE.

- Your VTECH 914 ADLi cordless telephone contains sophisticated electronic parts so it must be treated with care.

Avoid rough treatment

Place the handset down gently. Save the original packing materials to protect your telephone if you ever need to ship it.

Avoid water

Your telephone can be damaged if it gets wet. Do not use the handset outdoors in the rain, or handle it with wet hands. Do not install your base unit near a sink, bathtub or shower.

Remember that electrical appliances can cause serious injury if used when you are wet or standing in water. If your base unit should fall into water, **DO NOT RETRIEVE IT UNTIL YOU UNPLUG THE POWER CORD AND TELEPHONE LINE CORDS FROM THE WALL.** Then pull the unit out by the unplugged cords.

Electrical storms

Electrical storms can sometimes cause power surges harmful to electronic equipment.

For your own safety, use caution when using electric appliances during storms.

Cleaning your telephone

Your telephone has a durable plastic casing that should retain its luster for many years. Clean it only with a soft cloth slightly dampened with water or a mild soap. Do not use excess water or cleaning solvents of any kind.



IN CASE OF DIFFICULTY

If you have difficulty operating your phone, the suggestions below should solve the problem. If you still have difficulty after trying these suggestions, In the US call:

**VTECH Communications at
1-800-624-5688.**

THE PHONE DOESN'T WORK AT ALL.

- Make sure the power cord is plugged in.
- Make sure the telephone line cord is plugged firmly into the base unit and the telephone wall jack.
- Make sure the batteries are properly charged. If the LOW BATT indicator is on, the battery needs charging. If the IN USE indicators do not light when you press **PHONE**, you must charge the batteries.
- If you recently installed a new battery pack, make sure it is installed correctly.

NO DIAL TONE.

- First check all the suggestions above.
- If you still don't hear a dial tone, disconnect the base unit from the telephone jack and connect a different phone. If there is no dial tone on that phone either, the problem is in your wiring or local service. Call your local telephone company.

YOU GET NOISE, STATIC, OR A WEAK SIGNAL EVEN WHEN YOU'RE NEAR THE BASE UNIT.

- Place the handset in the base momentarily to re-set the security code. Then press **PHONE** to get a line.

Household appliances plugged into the same circuit as the base unit can sometimes cause interference. Try moving the appliance or the base unit to another outlet.

YOU GET NOISE, STATIC, OR A WEAK SIGNAL WHEN YOU'RE AWAY FROM THE BASE UNIT.

- You may be out of range. Either move close to the base, or relocate the base unit.
- The layout of your home may be limiting the range. Try moving the base unit to the second or third floor, or to some other location.

THE HANDSET DOES NOT RING WHEN YOU RECEIVE A CALL.

- Ensure that the ringer is turned on.
- Make sure the telephone line cord is plugged firmly into the base unit and the telephone jack. Make sure the power cord is plugged in.
- You may be too far from the base unit.
- You may have too many extension phones on your telephone line to allow all of them to ring. Try unplugging some of the other phones.

YOUR CALLER FADES IN AND OUT.

You may be nearly out of range. Move closer, or relocate the base.

YOU HEAR OTHER CALLS WHILE USING YOUR PHONE.

- Replace the handset in the base cradle, wait a few moments and try again.
- Disconnect your base unit from the telephone jack, and plug in a regular telephone. If you still hear other calls, the problem is probably in your wiring or local service. Call your local telephone company.



IN CASE OF DIFFICULTY

YOU HEAR NOISE IN THE HANDSET, AND NONE OF THE KEYS OR BUTTONS WORK.

- Make sure the power cord is plugged in.
- Your base unit and handset may not be operating on the same channel or security code. Place the handset in the cradle for a few moments to reload the security code and reset the channel.

COMMON CURE FOR ELECTRONIC EQUIPMENT

Electronics, like people, can sometimes get confused. If the unit does not seem to be responding normally, then try putting the handset in the cradle to re-initialize the unit. If it still does not seem to respond, perform the following steps (in the order listed):

1. Disconnect the power to the base.
2. Disconnect the handset battery.
3. Wait a few minutes.
4. Connect power to the base.
5. Connect the handset battery.
6. Put the handset in the base to re-initialize.



WARRANTY STATEMENT

WHAT DOES OUR WARRANTY COVER?

- Any defect in material or workmanship.

FOR HOW LONG AFTER THE ORIGINAL PURCHASE?

- One Year.

WHAT WILL VTECH DO?

- At our option, repair or replace your unit.

HOW DO I SEND MY UNIT, IN OR OUT OF WARRANTY?

- Call VTECH Communications customer service for Return Authorization at:
1-800-624-5688
- Properly pack your unit. Include any cables & accessories which were originally provided with the product. We recommend using the original carton and packing materials.
- Include in the package a copy of the sales receipt or other evidence of date of original purchase (if the unit was purchased within the last twelve months).
- Print your name and address, along with a description of the defect, and include this in the package.
- Include payment for any service or repair not covered by warranty, as determined by VTECH Communications.
- In the US, ship the unit via UPS Insured, or equivalent to:

VTECH COMMUNICATIONS
8770 SW NIMBUS AVENUE
BEAVERTON, OREGON 97008

VTECH Communications assumes no responsibility for units sent without prior Return Authorization.

WHAT DOES OUR WARRANTY NOT COVER?

- Batteries
- Damage from misuse, neglect, or acts of nature (lightning, floods, power surges, etc.)
- Products which may have been modified or incorporated into other products
- Products purchased outside the USA
- Products serviced by the owner or a service facility not expressly authorized by VTECH Communications
- Products purchased more than 12 months from current date

HOW DOES STATE LAW RELATE TO THIS WARRANTY?

- This warranty gives you specific rights. You may also have other rights which vary from state to state.



FCC REGULATIONS

This equipment complies with Parts 15 and 68 of the Federal Communications Commission (FCC) rules for the United States.

A label is located on the underside of the base unit containing either the FCC registration number and Ringer Equivalence Number (REN) or the IC registration number and Load Number. You must, upon request, provide this information to your local telephone company.

This equipment is compatible with inductively coupled hearing aids.

Should you experience trouble with this telephone equipment, please contact:

**In the United States:
VTECH COMMUNICATIONS
1-800-624-5688**

for repair/warranty information. The telephone company may ask you to disconnect this equipment from the line network until the problem has been corrected.

Your **914 ADLi** is designed to operate at the maximum power allowed by the FCC. This means your handset and base unit can communicate only over a certain distance - which will depend on the location of the base unit and handset, weather, and the construction and layout of your home or office.

FCC Part 15

Warning: Changes or modifications to this unit not expressly approved by the party responsible for compliance's could void the user's authority to operate the equipment.

The equipment has been tested and found to comply with part 15 of the FCC rules. These limits are designed to provide reasonable protection against harmful interference in a residential installation. This equipment generates, uses and can radiate radio frequency energy and, if not installed and used in accordance with the instructions, may cause harmful interference to radio communications. However, there is no guarantee that interference will not occur in a particular installation. If this equipment does cause harmful interference to radio or television reception, which can be determined by turning the equipment off and on, the user is encouraged to try and correct the interference by one or more of the following measures:

- Reorient or relocate the receiving antenna.
- Increase the separation between the equipment and receiver.
- Connect the equipment into an outlet or on a circuit different from that to which the receiver is connected.
- Consult the dealer or an experienced radio/TV technician for help.



FCC REGULATIONS

FCC Part 68

The FCC requires that you connect your cordless telephone to the nationwide telephone network through a modular telephone jack (USOC RJ11C or RJ11W).

Your telephone company may discontinue your service if your equipment causes harm to the telephone network. They will notify you in advance of disconnection, if possible. During notification, you will be informed of your right to file a complaint with the FCC.

Occasionally, your telephone company may make changes in its facilities, equipment, operation, or procedures that could affect the operation of your equipment. If so, you will be given advance notice of the change to give you an opportunity to maintain uninterrupted service.

The base unit contains no user serviceable parts. The handset contains a user replaceable battery pack.

If it is determined that your telephone equipment is malfunctioning, the FCC requires that it not be used and that it be unplugged from the modular jack until the problem has been corrected. Repairs to this telephone equipment can only be made by the manufacturer or its authorized agents or by others who may be authorized by the FCC. For repair procedures, follow the instructions outlined under the VTECH Limited Warranty.

This equipment may not be used on coin service provided by the phone company or Party Lines.

The REN is useful in determining the number of devices you may connect to your telephone line and still enable the devices to ring when you receive a call. The general rule is that the REN value should not exceed 5.0 total; however, contact your local telephone company for the specific number in your area.



TECHNICAL SPECIFICATIONS

FREQUENCY CONTROL

Crystal Controlled Dual PLL Synthesizer

TRANSMIT FREQUENCY

Handset: 925.05 MHz to 927.75 MHz (All ten channels within this range)

Base: 902.3 MHz to 905.0 MHz (All ten channels within this range)

RECEIVE FREQUENCY

Handset: 902.3 MHz to 905.0 MHz (All ten channels within this range)

Base: 925.05 MHz to 927.75 MHz (All ten channels within this range)

NOMINAL EFFECTIVE RANGE

Maximum power allowed by FCC and IC. Actual operating range may vary according to environmental conditions at the time of use.

SIZE

Handset: 18.2cm x 6.2cm x 3.8cm (L x W x T) maximum (antenna excluded)

Base: 21.0cm x 14.8cm x 5.5cm (L x W x T) maximum (antenna excluded)

WEIGHT

Handset: 250 grams

Base: 600 grams

POWER REQUIREMENTS

Handset: Self-contained nickel-cadmium rechargeable battery supply, 3.6V nominal, 600mAh capacity.

Power Adapter: 9V DC@500mA

SPECIFICATIONS ARE TYPICAL AND MAY CHANGE WITHOUT NOTICE.



VTECH COMMUNICATIONS LTD.

Distributed in the U.S.A. by VTECH Communications, 8770 SW Nimbus Avenue /
Beaverton, Oregon, 97008

Distributed in Canada by VTECH Electronics Canada Ltd., 200-7671 Alderbridge Way,
Richmond, B.C., V6X1Z9

Copyright 1996 for VTECH COMMUNICATIONS LTD.

91-4027-15-00
ISSUE 0





REGULARLY CLEAN CHARGE
CONTACTS
FOR SERVICE CALL VTECH AT
1-800-824-5688

MEMORY DIALING	
•	•
•	•
•	•
•	•
•	•

900 MHz
CORDLESS
914 AOL

VTECH

1 2 3 PUBUC

FULL



MAILBOX

POWER

DIGITAL ANSWERING
DEVICE

IN USE

ERASE

CHARGE



SPARE
BATT



VOL



ON



REPEAT

STOP

PLAY

SKIP



PAGE



VTECH[®]

CORDLESS TELEPHONE
MODEL: 914 ADLJ
FILE NO: E145260
DC9V 500mA

CLASS 2 POWER SOURCE ONLY

MANUFACTURED IN CHINA
VTECH COMMUNICATIONS LTD.

LISTED



4H00

LISTED



4H00

CANADA 1135 101 811A HAC
RENIIS: 0.4
IC: RSS/CNR 210

FCC ID: E1W780-4014-B4

COMPLIES WITH PART 68 FCC RULES
FCC REGISTRATION NO.: E1W780-23044 W9-E
RINGER EQUIVALENCE: 0.78
US00 JACK, RJ11C, RJ11R

THIS DEVICE COMPLIES WITH PART 15 OF THE
FCC RULES. OPERATION IS SUBJECT TO THE
FOLLOWING TWO CONDITIONS: 1) THIS DEVICE
MAY NOT CAUSE HARMFUL INTERFERENCE;
AND 2) THIS DEVICE MUST ACCEPT ANY
INTERFERENCE RECEIVED, INCLUDING
INTERFERENCE THAT MAY CAUSE UNDESIRABLE
OPERATION.

PRIVACY OF COMMUNICATIONS MAY NOT BE
ENSURED WHEN USING THIS PHONE.



© 2004 VTECH

© 2004 VTECH





